

HS-1920TC

Thermal IP camera

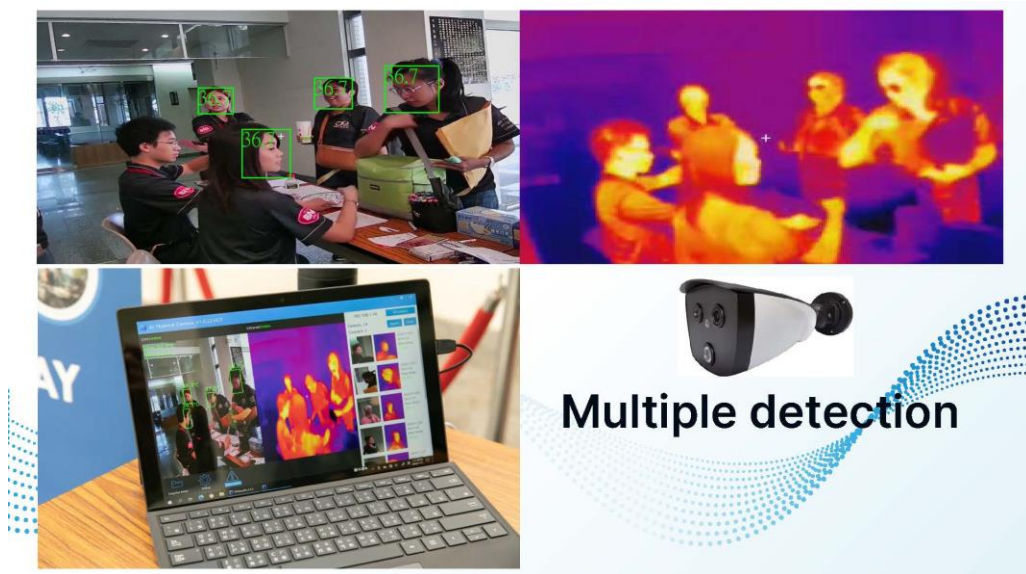

Application Diagram

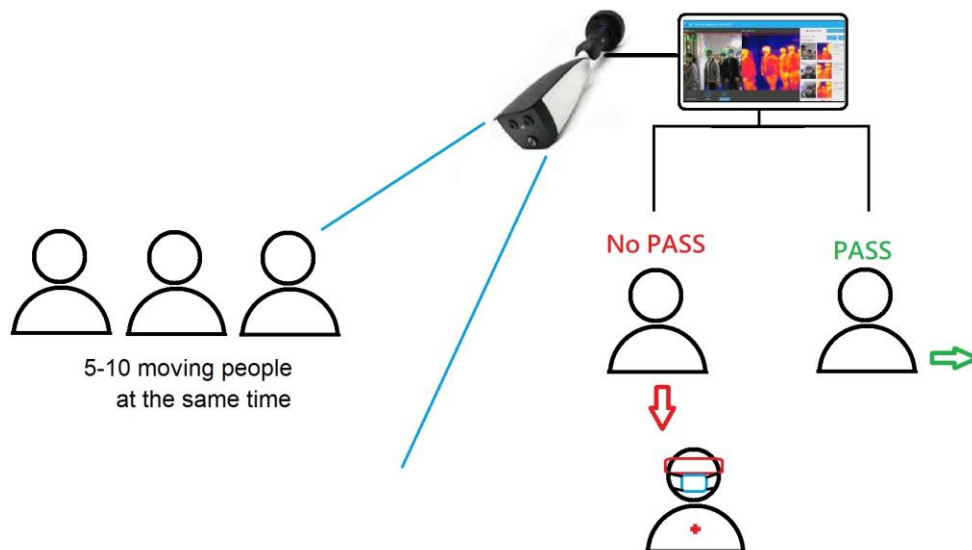

Features

- High sensitivity Thermal module & image processing technology
- Body temperature range: 35°C to +50°C
- Face-tracking technology, 5-10 people simultaneously moving
- AI technology with smart storage function
- Black body accessories to ensure the accuracy $\pm 0.3^{\circ}\text{C}$
- Monitoring software with AI learning
- IP66 enclosure

Specifications

Thermal	
Image sensor	Vox Uncooled Focal Plane Arrays
Resolution	256x192
Pixel Interval	12pm
NETD	Less than 60 mK (@25°C.F#=1.1)
Aperture	F1.0
Field of View	35° x 27° (H x V)
Optical	
Image sensor	1/2.8" 2.0M Pixel CMOS
Resolution	1920x1080P
Min. Illumination	Color: 0.005Lux @ (F1.2, AGC ON), B/W 0.001 μm @ (F1.2, AGC ON)
Field of View	84° x 45° (H x V)
Focal Length	4mm
Shutter Speed	1s to 1/100,000s
White Balance	Auto/Manual/ATW (Auto-tracking White Balance)/indoor/outdoor/Daylight Lamp/Sodium Lamp
Day& Night	ModeIR cut filter with auto switch
WDR	80 dB
Functions	
Bi-spectrum Image Fusion	Fusion view of thermal view and overlaid details of the optical channel
Picture in Picture	Combines details of thermal and optical image PIP, overlay thermal image

	on optical image
Face snapping	Built-in deep learning AI algorithm, Supports simultaneous detection
Temperature Measurement	Support global and local temperature
Temperature Range	-15°C to +150°C
Temperature Accuracy	Target temperature 35°C ^ 38°C ±0.3 °C Target temperature 20°C ^ 33°C ±0.6 °C Target temperature 38°C ^ 50°C ±0.6 °C
Network	
Stream	(Main) Thermal: 25fps(1920 x 1080, 1280 x 720) (Sub) Thermal: 25fps(704 x 576, 352 x 288)
Compression	Video: H.264 (Baseline/Main/High Profile) /MJPEG/H.265 Audio: G.711u/G.711a/G.7221/MP2L2/G.726/PCM
Protocols	TCP/IP, ONVIF, GB/T 28181, DHCP, RTP, RTSP, PPPoE, UPnP, UDP
API	ONVIF (Profile S, Profile G, Profile T), SDK
Environment	
Operating temp.	-20 ~ +55° C
Humidity	< 95%
Physical	
Dimension	246(L) * 101(W) * 81(H) mm
Weight	1000gs approx.
Optional accessories	
Black body	



Provided by Hot Stuff Intl. Co., Ltd.

For more information, contact: service@hotstuff.com.tw